



HERITAGE

- REDROW -

THE AVON 3

THREE BEDROOM HOME



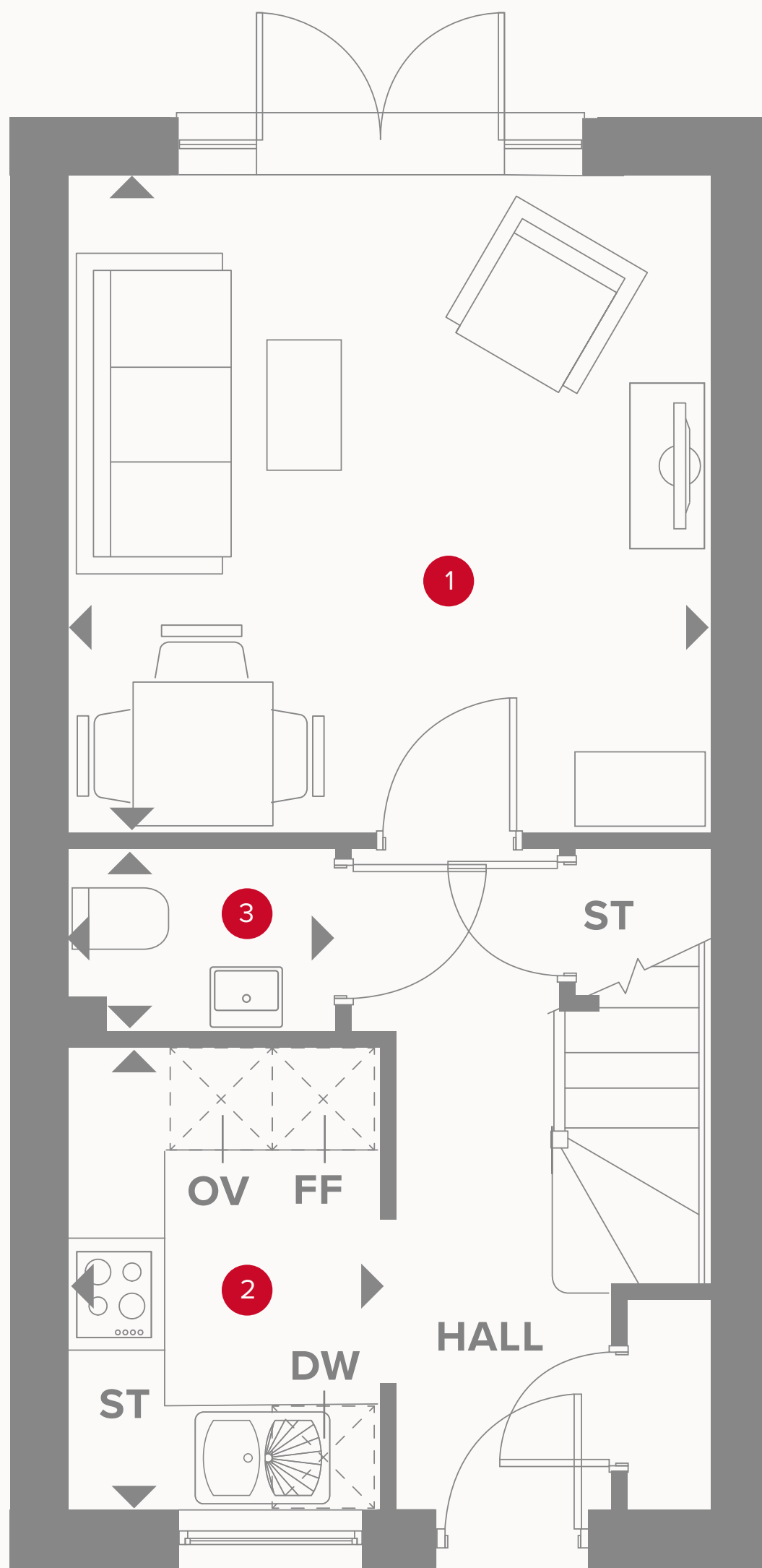

THE AVON 3 GROUND FLOOR

1	Lounge/Dining	12'10" x 12'7"	3.95 x 3.86 m
2	Kitchen	9'1" x 6'2"	2.78 x 1.89 m
3	Cloaks	5'3" x 3'6"	1.62 x 1.11 m



KEY

	Hob
OV	Oven
FF	Fridge/freezer
DW	Dishwasher space

	Dimensions start
ST	Storage cupboard

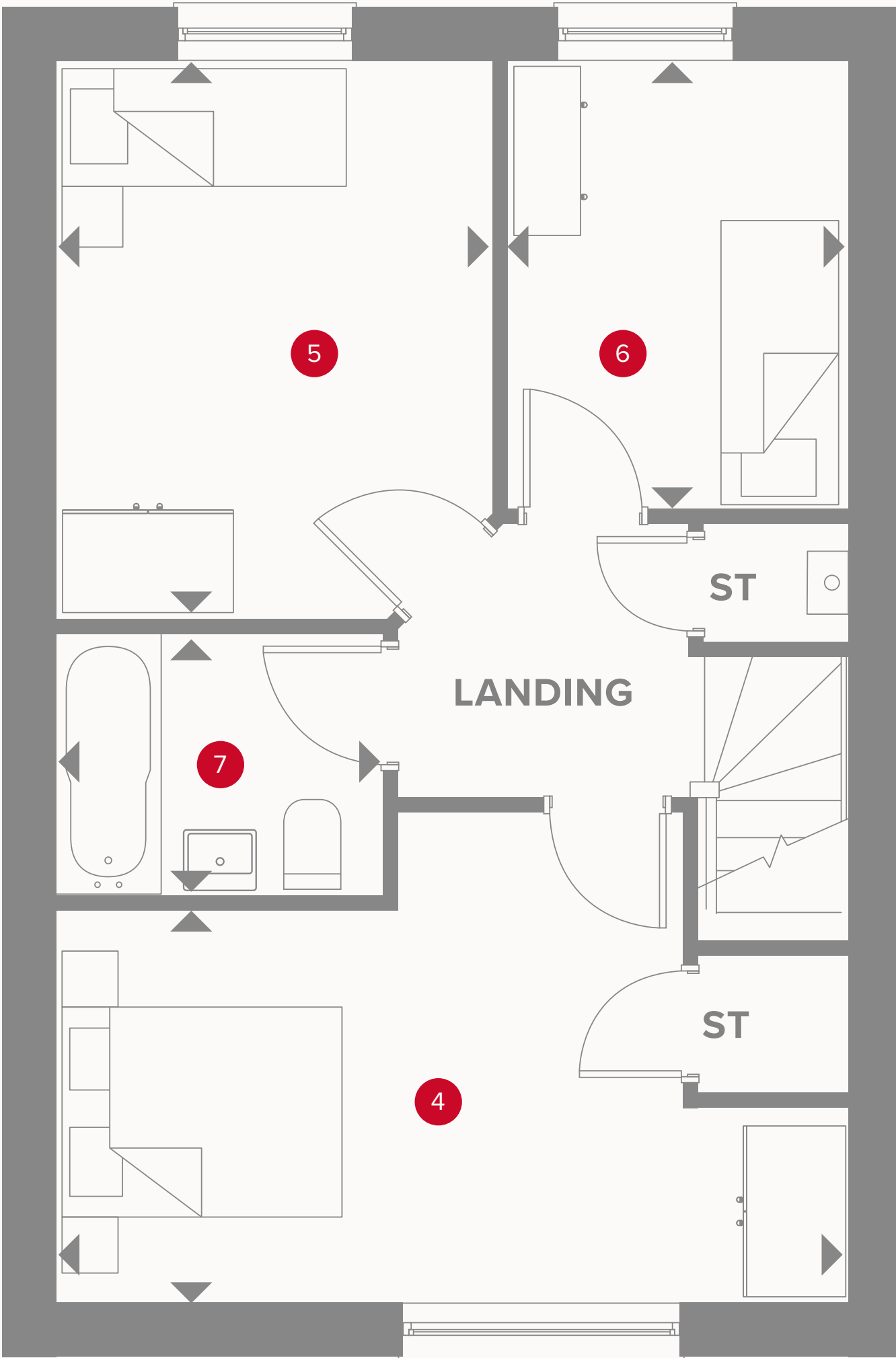

THE AVON 3 FIRST FLOOR

4	Bedroom 1	16'8" x 10'4"	5.12 x 3.17 m
5	Bedroom 2	11'8" x 9'3"	3.60 x 2.82 m
6	Bedroom 3	9'5" x 7'3"	2.89 x 2.22 m
7	Bathroom	6'9" x 5'6"	2.10 x 1.71 m



KEY

◀ Dimensions start

ST Storage cupboard

**CONSUMER
CODE FOR
HOME BUILDERS**

www.consumercode.co.uk

Customers should note this illustration is an example of the Avon 3 house type. All dimensions indicated are approximate and the furniture layout is for illustrative purposes only. Homes may be 'handed' (mirror image) versions of the illustrations, and may be detached, semi-detached or terraced. Materials used may differ from plot to plot including render and roof tile colours. Detailed plans and specifications are available for inspection for each plot at our Sales Centre during working hours and customers must check their individual specifications prior to making a reservation.