

VENTILATION:
System 3 - Continuous Mechanical Extract

EnviroVent Filterless Extract Fan - ECO dMEV: 100mm constant volume, continuously running extract fan for a wall or ceiling installation provided to kitchens, bathrooms, shower rooms and WC's with rigid PVC ducting to suitable wall or roof terminals (shown dashed). The use of flexible ducting shall be limited to final connections to fans and terminals.

ECOsensor model HT - fitted with an adjustable integral humidity sensor and timer to boost the fan when the humidity in the room reaches a pre-set level. It can also be boosted by an external switch. The timer is adjustable between 1 and 30 minutes.

Kitchen fans shall generally be positioned near to cooking space and electric spur available for possible future hood.

Designed to comply with System 3 of the Building Regulations.

All doors to be undercut by a minimum of 10mm to permit airflow.

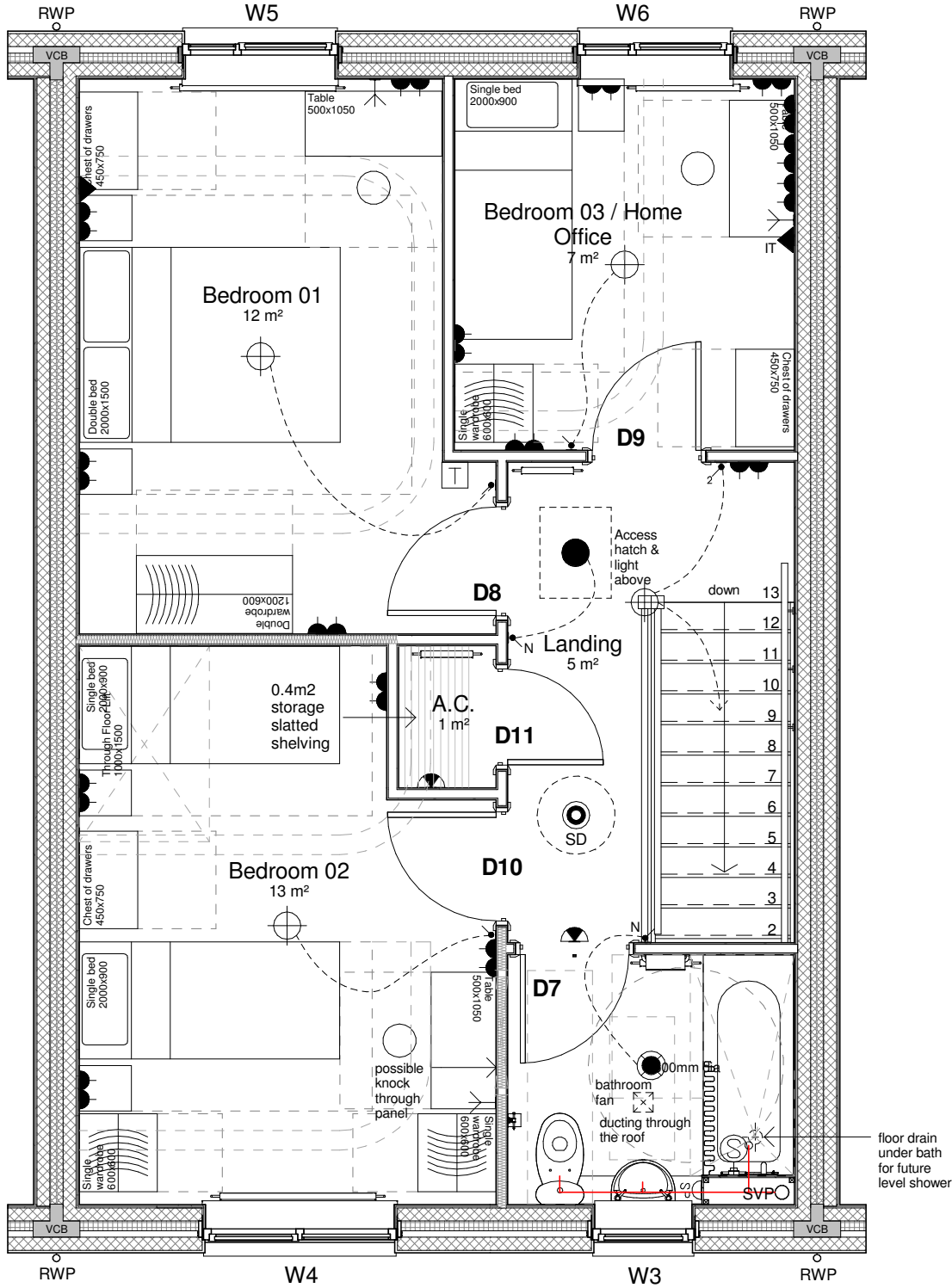

CONSTRUCTION ISSUE

29/02/16

First Floor M&E Plan

1 : 50

M&E Legend:

POWER

- Fused spur Isolator
- Fused spur Isolator with neon indicator
- Unswitched spur at low level
- Switched spur at high level
- Switched spur above w/t to unswitched socket below
- Single switched socket
- Double switched socket
- Single switched socket above w/t
- Double switched socket above w/t
- Shaver point
- Cooker point
- Appliance switch - FF, DW, WM, TD etc. connected to low level sockets behind appliances. All sockets to connect to a central control panel located above worktop level
- Consumer service unit (fixed 1550mm above FFL where possible; 1050mm in wheelchair units)

LIGHTING

- One way switch (large rocker type)
- Two way switch (large rocker type)
- Neon light indicator switch (large rocker type)
- Dimmer light switch (large rocker type)
- External light point, dedicated low energy fitting, operated via an integral PIR with internal override switch with neon indicator
- External light point, dedicated low energy fitting, operated via an integral photo electric cell sensor with internal override switch with neon indicator
- Elevation - external light point
- Ceiling light point - pendant type
- Ceiling light point - drum type
- Ceiling light point - drum type light enclosed in IP4 rated splash proof finish
- Ceiling light point - controlled by a dimmer switch in addition to the hall lighting
- Ceiling light point - recessed downlighter
- Ceiling light point - 5nr GU10 spot light fittings on track in satin chrome finish
- Wall mounted light point
- Under wall-cupboard task lighting point to kitchens

COMMUNICATION

- T.V. point - (1no. 'dual core/co-axial for SKY+ HD)
- B.T. point
- B.T./Internet socket (cat 5 cable)
- Double telephone (B.T.) socket
- Openreach equipment to approved layout

MECHANICAL VENTILATION

- Ceiling mounted dMEV fan to discharge through wall or roof - see individual notes on drawing (see first floor carcassing plan)
- Cooker Hood Extract Fan

SECURITY AND FIRE SAFETY

- Mains operated smoke detector with battery back-up
- Mains operated heat detector with battery back-up
- Mains operated CO detector with battery back-up
- Illuminated Bell push
- Bell sounder
- Bell transformer

PLUMBING AND HEATING

- External tap
- Gas connection point
- Shower with mixer valve
- Electric shower
- Thermostat
- Boiler programmer (to include a Downtimer clock)
- Radiator
- Heated towel rail

DRAWING NOTES:

- This Drawing must not be scaled.
- To be read in conjunction with all other project drawings.
- All Details and drawings must be read in conjunction with the 15031 - General Construction Notes.
- For Details of Revisions refer to Contents Sheet.

This drawing must not be scaled. Figured dimensions and levels to be used. Any inaccuracies must be notified to the architect. Detail drawings and large scale drawings take precedence over smaller drawings.

A3

THIS DRAWINGS IS COPYRIGHT ©

Rev:	Chk'd:	Rev:	Chk'd:
A			
Revised following comments from Lovell issued 15.09.15. Issued for CONSTRUCTION. - ZL			
24.02.16			

PRELIMINARY	
PLANNING	
DESIGN	
TENDER	
CONSTRUCTION	✓

powelldobson
ARCHITECTS

Cardiff Office: Charterhouse, Links Business Park, St Mellons, Cardiff, CF3 0LT
Tel: +44 (0)33 20719 9999 Fax: +44 (0)33 20719 1212 email: cardiff@powelldobson.com

Contract: Aston Mead, Shotton
House 3B5P Version 2
Title: First Floor M&E Layout

Scale: As indicated
Date: 14/08/15
Drawn: ZL
Checked: BK

POA Job No:	DRG NO:	ME	11	REV
15031	3B5PV2 01			A
VOLUME	LEVEL	DR TYPE	NUMBER	